



Kinetic Facades

Infinite Extraordinary & Unique Possibilities

Boegger Industech Limited

Add: No. 15, Jingwu Road, Hightech Zone, Anping County, Hengshui City,
Hebei Province, China 053600

Website: www.boegger.com

E-mail: sales@boegger.com



Surely many designers will be obsessed with building facades, it's getting harder to make extraordinary facades which is limited by tight budget or technical constraints.

Facade, as the important role of building, its design, production and installation are indispensable procedures in the quality control process. Of which, the most important part is design. It fundamentally determines the quality of the facade.

Boegger, has the ability and experience to design, produce qualified and extraordinary facades for your projects. Now, we recommend the new products - kinetic facades as your building facade material. Its simple structure and conspicuous effect will be amazing design.



KINETIC FACADES /CLADDING

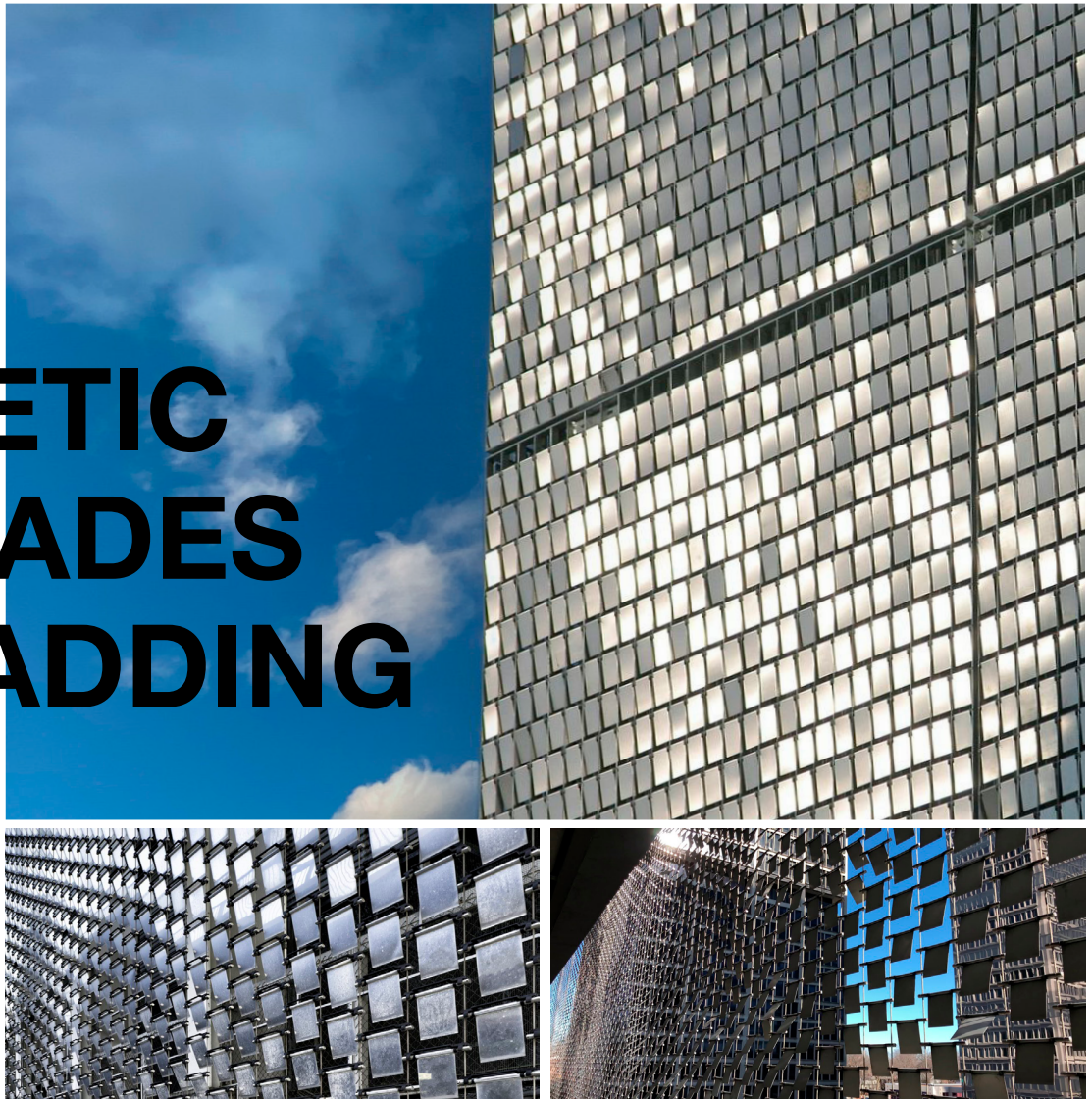

Kinetic architecture is more and more popular in facades/cladding designs, because it adds a new dimension to the built environment, in line with an increasing trend towards moving structure. The shimmering wave effect defines that architecture is no longer rigid and static and it has numerous extraordinary and unique possibilities.

Kinetic Cladding, an articulated system, by simulating wind blowing effect with dynamic wind to display different and shiny wavy effects, changes dynamically, it is made up of freely-moving aluminum, stainless steel or copper material sheets. Gusts of wind and passing traffic cause the metal rectangles to ripple in an ever-changing display, a playful rhythm of reflected light.

- 1 Flexible moving in the wind and reflect light for different shining and beautiful reflect.
- 2 Straight or staggered arrangement satisfy different effect display and different installation environments.
- 3 Frame, back plates and stainless steel wire rope installation method can be flexible installation in different building facades.
- 4 Anti-corrosion surface treatment and material guarantee the long life and needs less maintenance.
- 5 Custom tailored designs including surface, material and patterns provide extraordinary effect with others.
- 6 Low noise and dazzle from the waving cladding would not prove a problem for passing motorists.

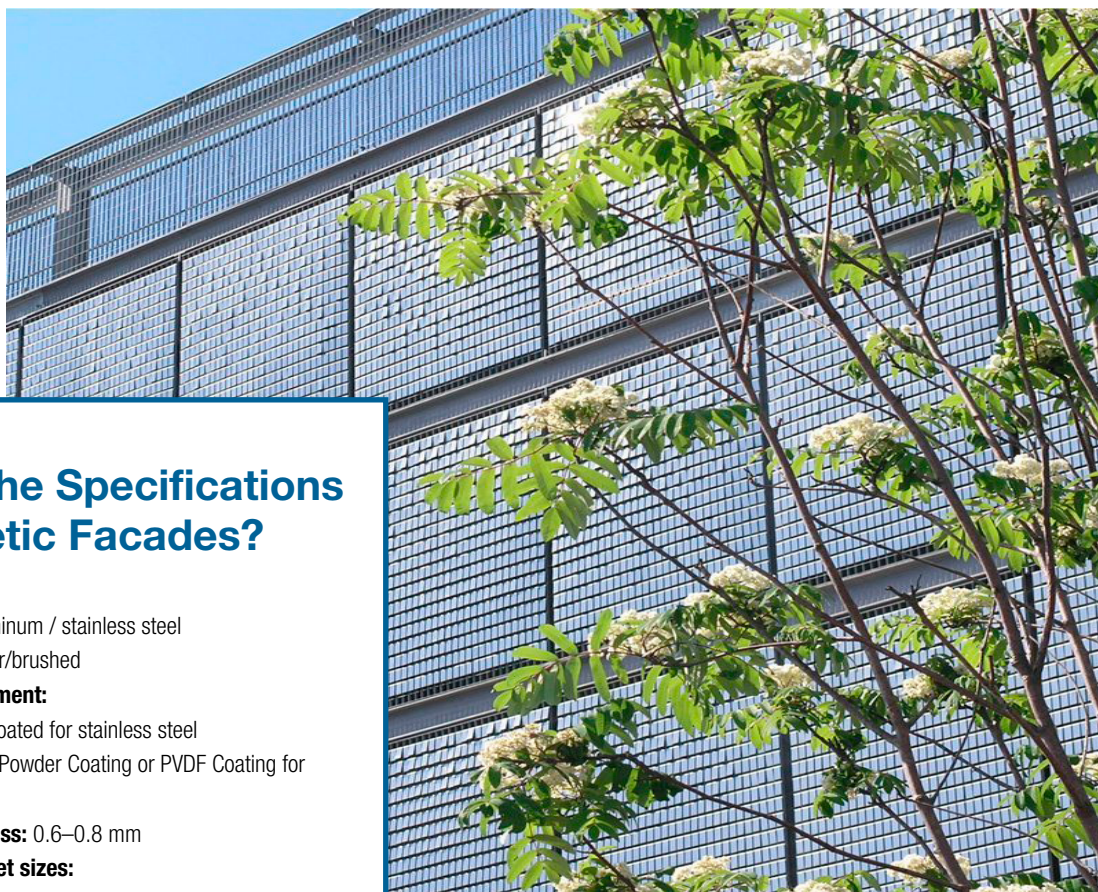

What the Specifications of Kinetic Facades?

Material: aluminum / stainless steel

Surface: mirror/brushed

Surface treatment:

- Titanium Coated for stainless steel
- Anodizing, Powder Coating or PVDF Coating for Aluminum

Sheet thickness: 0.6–0.8 mm

Standard sheet sizes:

- 150 × 180 mm, 150 mm × 190 mm,
- 120 mm × 120 mm, 120 mm × 150 mm,
- 90 mm × 120 mm (other sizes can be customized)

Sheet vertical spacing:

- 30–50 mm (varies based on different projects)

Colors: customized.

Stainless steel wire rope diameter:

- 3.0 mm, 5.0 mm, 6.0 mm or 8.0 mm.

Rail diameter: 6.0 mm, 8.0 mm or 10.0 mm.

Custom Service

Our kinetic facade design will follow the architectural style, modelling and give attention to not only the beauty it displays, as well as the safety, economy, performance and functions. Besides, we will consider the installation feasibility at different facades and maintenance issues in advance. After knowing the native structure, lightning, landscape, indoor design and other matters, we will design a perfect solution to your projects.

// 01

Different Colors

Ti-plated stainless steel plates supply multiple and even surface to supply more beauty.

// 02

Mirror or Brushed Surface

Except for Mirror surface, we can custom the brushed surface if you like it.

// 03

Perforated Patterns

Perforate holes on stainless steel plates with your logos or other designs are available to enhance building beauty.

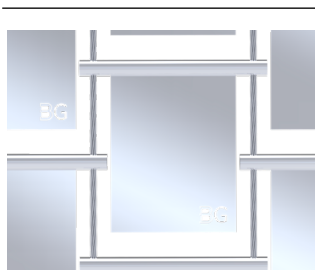

Mirror Surface

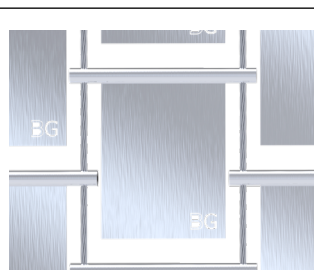

Brushed Surface

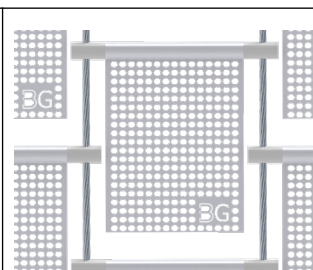

Perforated Patterns

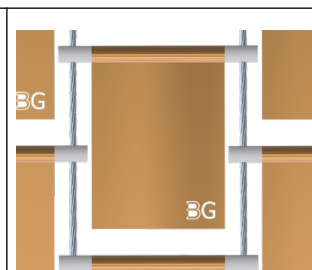

Copper Surface

How to Install Kinetic Facades/Cladding?

Here are three types of installation method for different sites and facades.

KEEL MOUNTING

Satisfy most of installation environments and supply reliable support

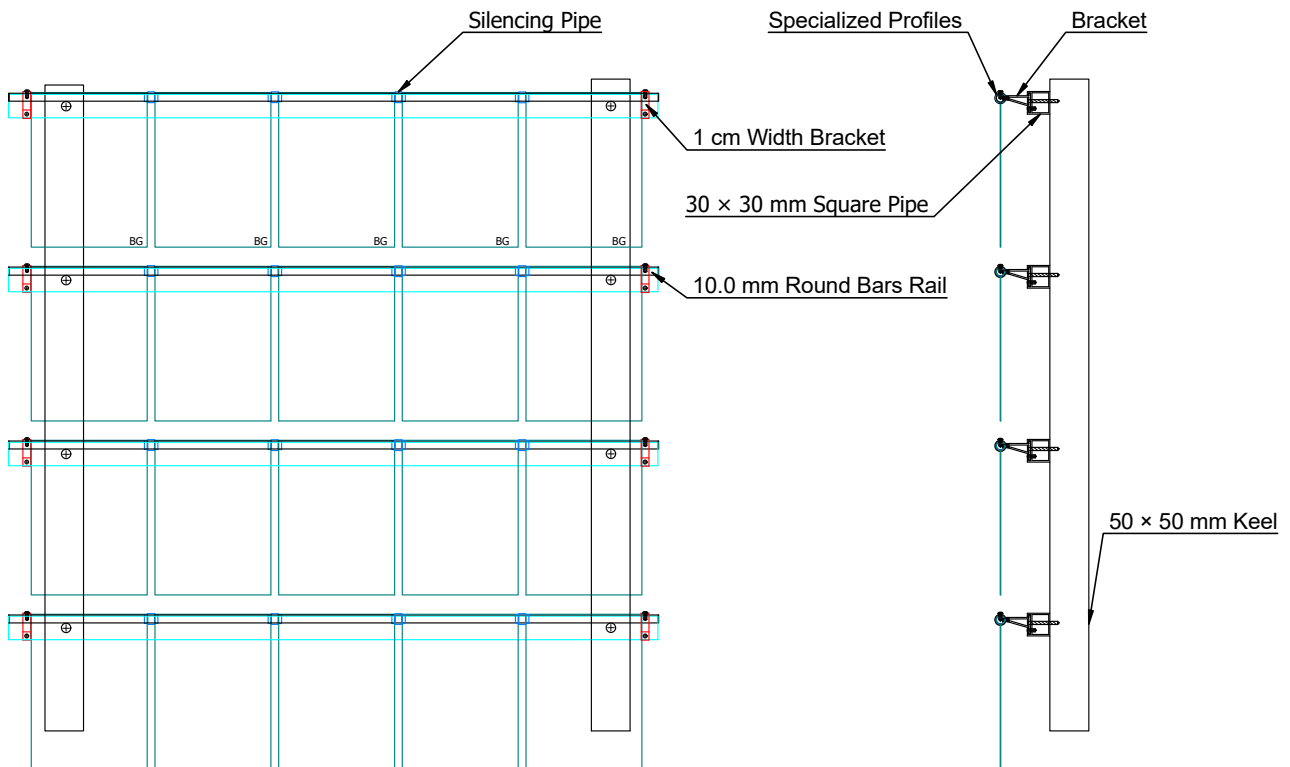

a) Install the 50 × 50 mm keel onto the facades.

b) Fasten the 30 × 30 mm square pipe onto the keel as designed distance.

c) Install the stainless steel sheets, silencing pipe one by one onto the rails.

d) Fasten the rails onto the square pipes with bracket.



BACK PLATE MOUNTING

Suitable for small area mounting

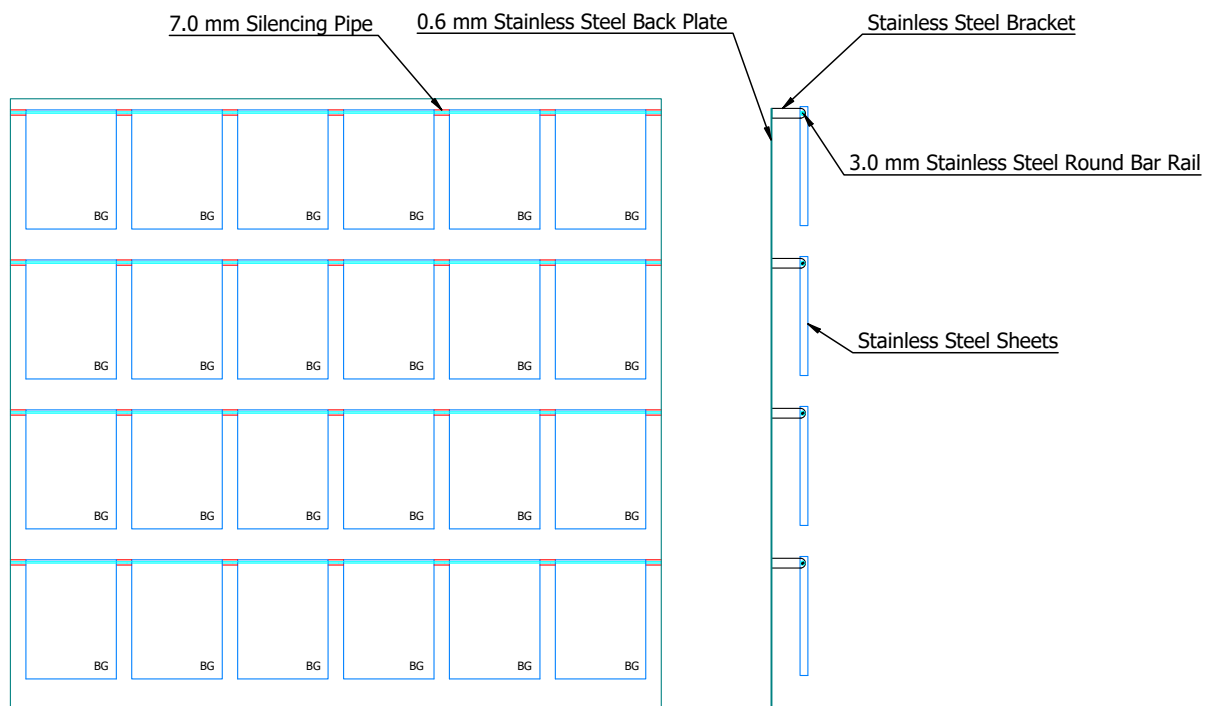

- a) Fasten the 0.6 mm stainless steel plates onto the facades.
- b) Install the stainless steel bracket onto the back plates.
- c) Install the stainless steel sheets and silencing pipe onto 3.0 mm stainless steel rails.
- d) Install the rails onto the stainless steel bracket.

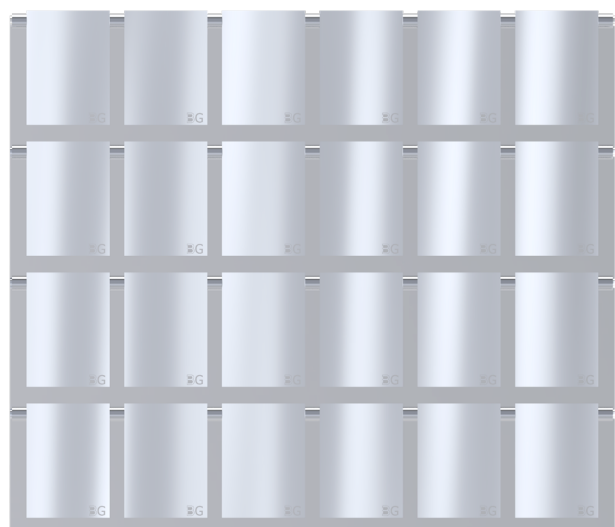

HANGING MOUNTING

Suitable for glass facades or facades where the H beam mounting is hard to construction

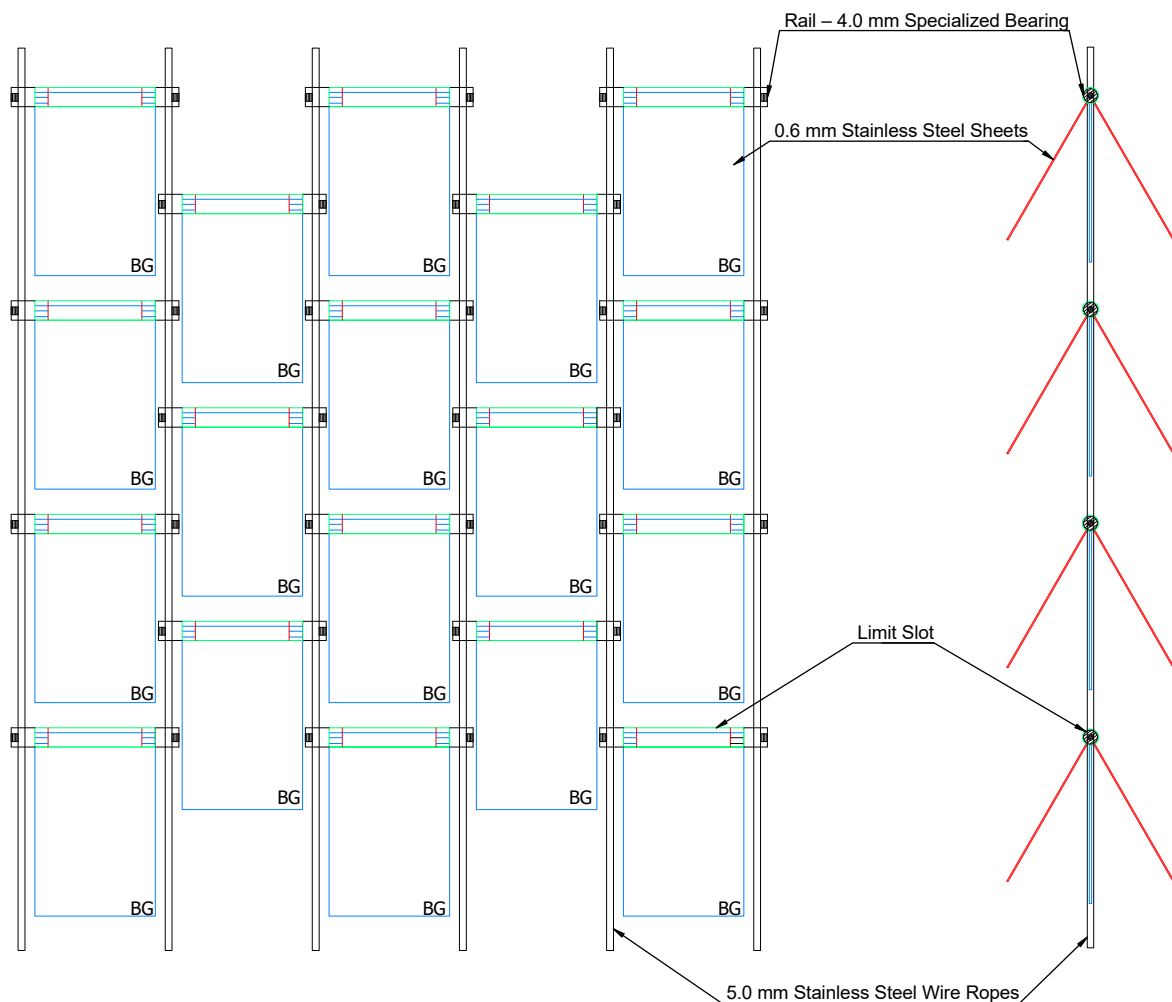

- Install the 50 × 50 mm keel onto the facades.
- Fasten the 30 × 30 mm square pipe onto the keel as designed distance.
- Install the stainless steel sheets, silencing pipe one by one onto the rails.
- Fasten the rails onto the square pipes with bracket.

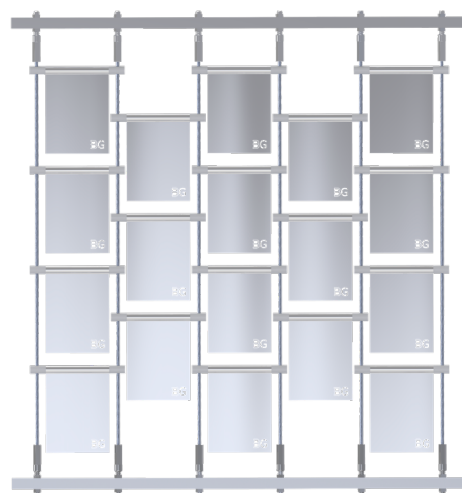

ENJOYS THE BEAUTY OF KINETIC FACADES

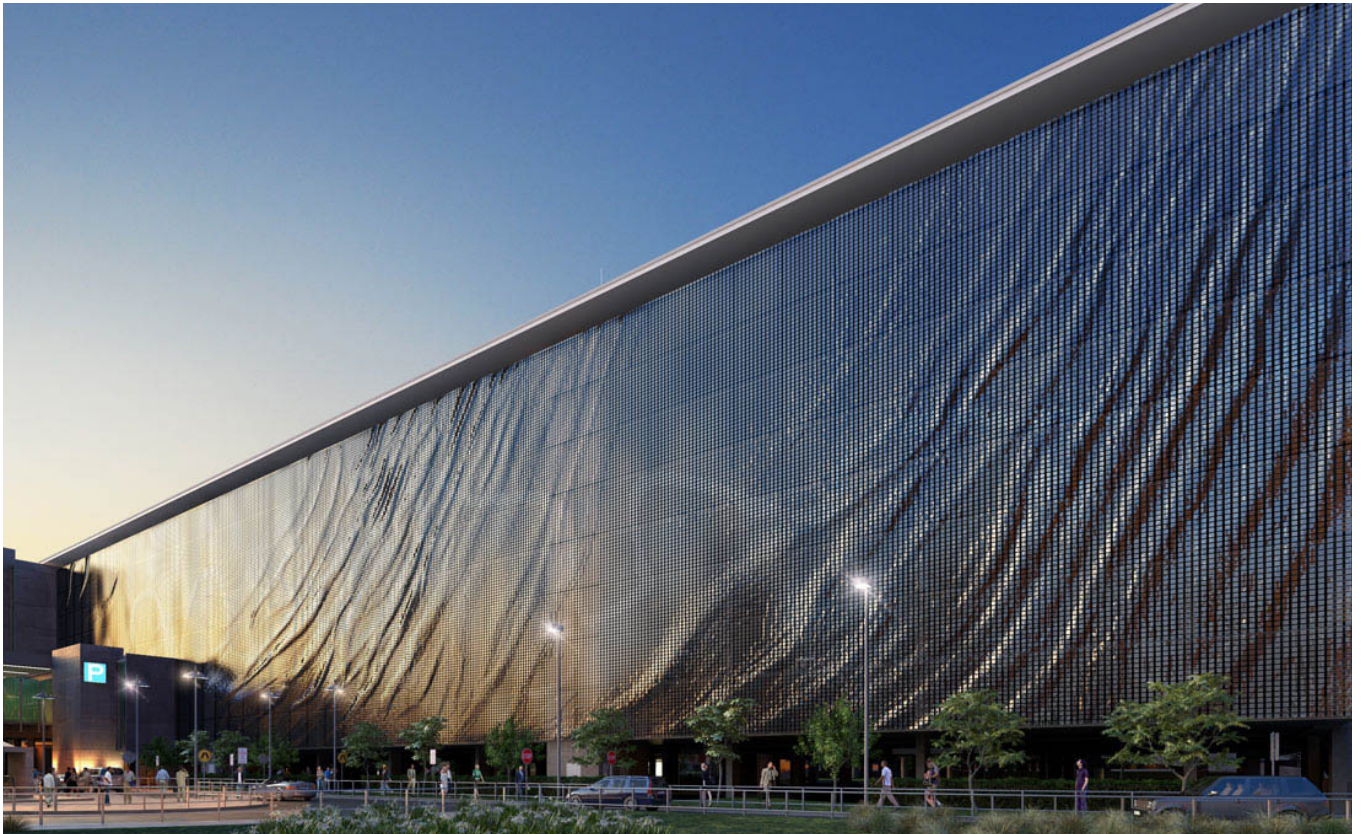

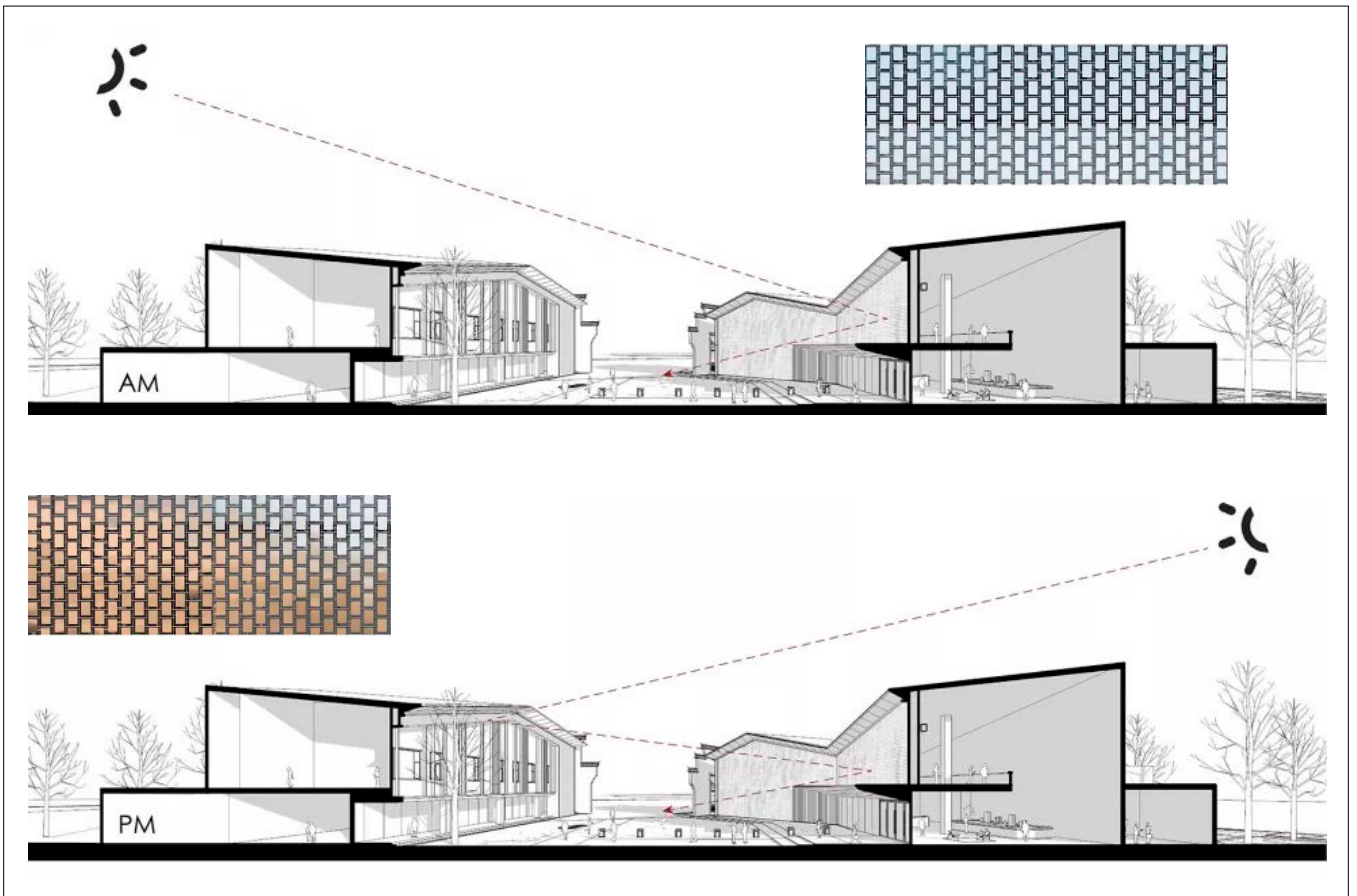

Kinetic Facades

Infinite Extraordinary & Unique Possibilities

Boegger Industech Limited

Add: No. 15, Jingwu Road, Hightech Zone, Anping County, Hengshui City,
Hebei Province, China 053600

Website: www.boegger.com

E-mail: sales@boegger.com

